

INSTALLATION OF SWIVEL TYPE NOZZLE TIPS AND CHECKS

Swivel Type Nozzle tips are held in place with a keeper. A #10-32 button head cap screw secures keeper and tip to the nozzle body. This nozzle uses check & spring assembly #570-85017.

To install nozzle tip or check & spring assembly:

1. Grasp the check-spring and twist onto the projection of the check-ball.
2. Make sure the pocket and ball are free of contaminants to insure a good seal.
3. Place the check & spring assembly; ball first into the nozzle body (Make sure it seats properly).
4. Insert the O-ring end of nozzle tip into the nozzle tip pocket with a slight twist and secure with keeper.

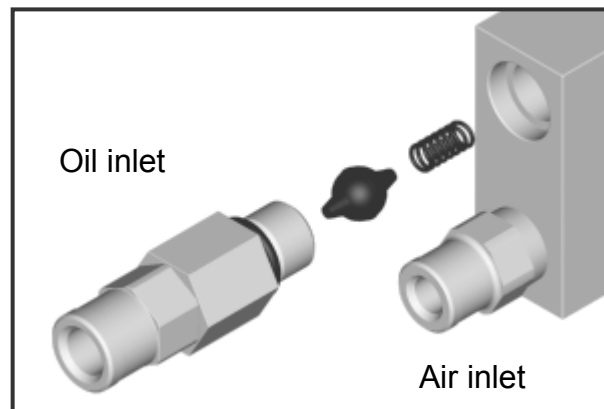

INSTALLATION OF REVERSE CHECK NOZZLE TIPS AND CHECKS

Reverse Check nozzle assemblies are usually a Swivel Type with the exception that the nozzle tip pocket does not contain the check. (Note: some older style nozzles may have a thread-in style tip). There is a 1/2" hex by 1/2" long stainless steel Reverse Check Fitting which retains the check & spring assembly. This nozzle uses check & spring assembly #570-85017.

To install nozzle tip:

1. Make sure the o-ring and nozzle tip pockets are free of contaminants to insure a good seal.
2. Insert the O-ring end of nozzle tip into nozzle tip pocket with a slight twist and secure with keeper or if you have a thread-in type tip; screw in tip until flush with body.

To install Check Assembly:

1. Grasp the check-spring and twist onto the projection of the check-ball.
2. Make sure the pocket and ball are free of contaminants to insure a good seal.
3. Place the check & spring assembly, spring first into the nozzle body (Make sure it seats properly).
4. Screw in the Reverse Check fitting until flush with body.

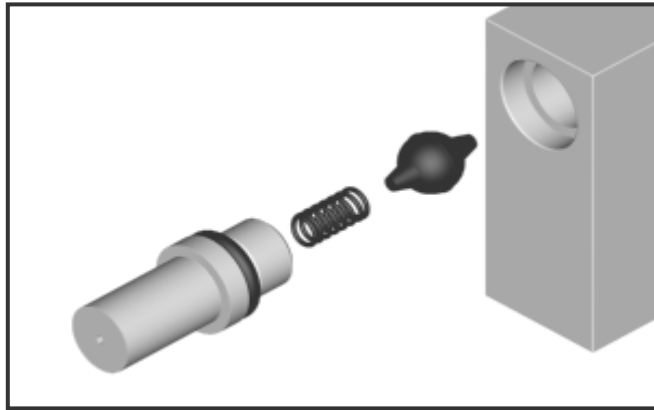

INSTALLATION OF THREAD-IN NOZZLE TIPS AND CHECKS

A Thread-In nozzle assembly uses Check Assembly #570-85017.

To install nozzle tip or check & spring assembly:

1. Grasp the check-spring and twist onto the projection of the check-ball.
2. Make sure the pocket and ball are free of contaminants to insure a good seal.
3. Place the check & spring assembly, ball first into the nozzle body (Make sure it seats properly).
4. Screw in the nozzle tip until flush with body.

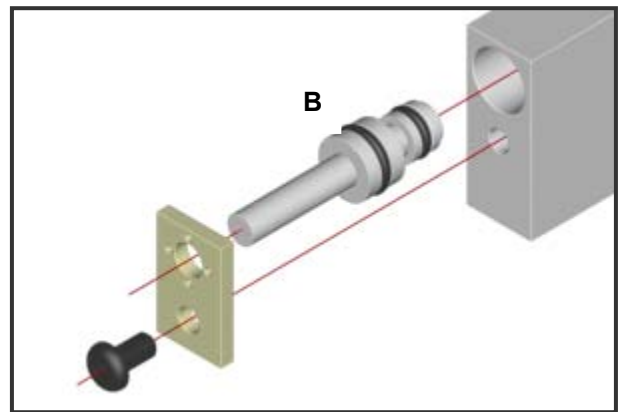
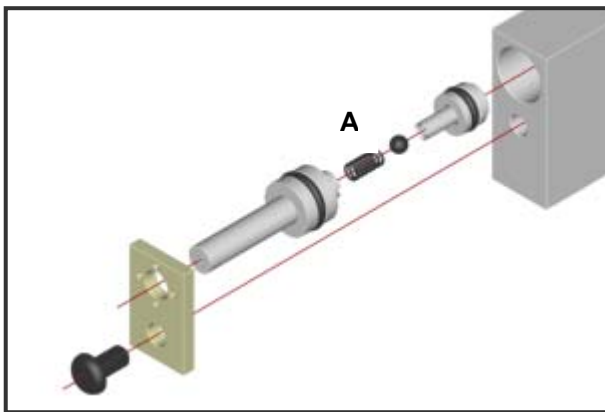

INSTALLATION OF TUBE TYPE NOZZLE TIPS AND CHECKS

Tube type nozzle tips are held in place with a keeper. A #10-32 button head cap screw secures keeper and tip to nozzle body. The nozzle tip contains a check & spring assembly #570-85278.

A. *To install check & spring:*

1. Remove the inner oil tube from the nozzle tip.
2. Make sure the old check and spring assembly has been removed.
3. Make sure inside of the nozzle tip and the check ball are free of contaminants, to insure a good seal.
4. Drop the check-spring into the nozzle tip.
5. Drop the check-ball into the nozzle tip.
6. Reinsert the inner oil tube into the nozzle tip.
7. The tip is now ready for installation into the nozzle body.

B. *To install nozzle tip:*

1. Grasp the tip making sure inner oil tube does not fall out.
2. Make sure the pocket and O-rings are free of contaminants to insure a good seal.
3. Insert the o-ring end of nozzle tip into the nozzle tip pocket with a slight twist and secure with keeper.